

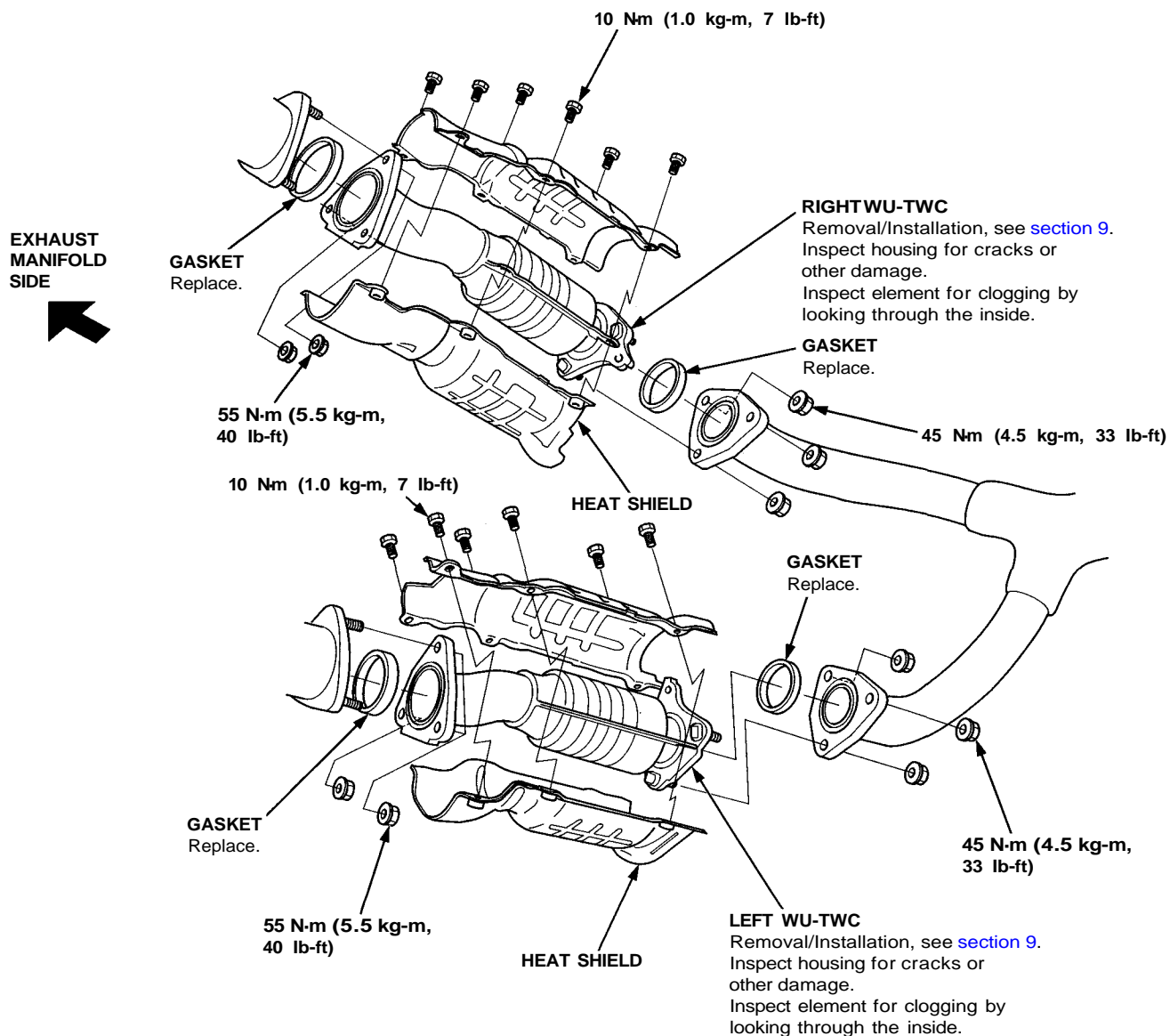

Inspection

If excessive exhaust system back-pressure is suspected, remove the TWC from the car and make a visual check for plugging, melting or cracking of the three way catalyst. Replace the TWC if any of the visible area is damaged or plugged.

WU-TWC:



(cont'd)

Emission Control System

Three Way Catalytic Converter (TWC) (cont'd)

TWC:

TWC

Removal/Installation, see [section 9](#).
Inspect housing for cracks or other damage.
Inspect element for clogging by looking through the inside.

